



TECHNICAL INFORMATION 2008-2009

STAGE DIMENSIONS

Proscenium opening (width)	48'
Proscenium height (to fixed Valance)	23' 7"
Stage width, (Wall to wall)	85'
Fire Curtain Pocket to Back Wall	39'6"
Fire Curtain Pocket to Stage Lip	3'1"
Stage to gridiron	65'3"
Stage to loading rail	53'
Projection booth to Centre stage	153'
Stage lip to back of Orchestra level seating	89'
Stage lip to Mezzanine overhang	45'
Auditorium width (House)	72'
Orchestra Pit, curved front	42'X10', accommodates 25

STAGE EQUIPMENT & SPECIFICATIONS

Available Power Supply

- 1: 600 amp 3-phase disconnect panel
- 2: 200 amp 3-phase disconnect panel (Independent sources, both located down stage left)

Lighting

Rack mounted MD 288 series dimmer bank (under stage)

- 2.4kw dimmers wired dimmer per circuit (see circuit layout)

Teatronics Producer II 248

- 48 channel computer assisted control board
- DMX 512 Multiplex protocol and AMX 192
- 36 submasters, 10 dedicated, 5 show memory

Stage Managers Panel (located downstage left)

- 6 channel house-light control with master
- 6 channel stage circuit control with master
- DMX-512 control input receptacles located stage left and in House mix position.

Lighting fixtures

- 3: On-stage overhead strip lights (border lights). Each 50' strip has 72: 200-watt lamps broken into 4 circuits. (4 colors possible) See lineset plot for locations.
- 16: FOH, 19 degree Source four ellipsoidals on Box Booms
- 5: 512-watt source four instruments in A.P. position fixed focus down light on Orchestra pit/thrust.
- 2: Lycian XLT 1290 2kilowatt Xenon Followspots.



Stage Rigging

- 45 Linesets, Upright double purchase, 52' batten length
- Fly-rail located stage right, 15' above stage.
- 1,200 pound capacity Per Batten
- Loading gallery is 53' above stage floor

Stage Goods

- 1 pair royal purple grand drapes on traveler, 28'h x 28'w
- 1 royal purple fixed valance @ 23' 7" trim.
- 1 royal purple valance/border downstage of grand drape. (adjustable trim)
- 5 pairs of black legs 28'h x 12'w and 4 black borders (100% fullness)
- 1 pair of black panels on traveler, 28'h x 28'w (full stage black)
- 1 natural, seamless muslin Cyclorama, 28'h x 52'w
- 1 black sharks tooth scrim 28'h x 52'w
- All stage goods rated "IFR" (Inherently Flame Retardant)
- **Orchestra Acoustic Shell**, Wenger Diva acoustic shell. More info available on request

Load In

There are two ways to get equipment onto the stage;

- **Freight Elevator**, 7'7" deep X 5'10" wide X height Door opening is 5'10" w X 6'8" h
- **Loading Doors**, 16'h X 9'6" w at stage level. 14' above street level loading zone with 3 ton winch mounted on an I-beam track.
- **Stage door**, Backstage entrance from loading zone on Park St. 2 flights of stairs.

Support Space

- **Dressing Rooms**, Ten 9'x 9', 5 on stage level, and 5 one floor up from stage level, each with sink, makeup counter and lighted mirror.
- **Green Room**, Located under stage, 43'x 40'. Access to stage or orchestra pit.
- **Chorus Room**, Adjacent to Green room, 25'x 30'. Make up counters and lighted mirrors.

Sound Reinforcement

- **Cluster**, Located above the proscenium arch, consisting of 2) 18" EV Bass drivers, 4) 10" EV Midranges, and 2) EV High frequency compression drivers. Powered by 3 BGW amps controlled by DBX x-over.
- Additional coaxial reinforcement speakers located under balcony.
- Rolls 8 channel Microphone Mixer
- Tascam CD Player / cassette deck
- VMA has 3 Shure SM58 mics with stands.

VMA Line-set Schedule

#	FROM PLASTER	DESCRIPTION (IF IT'S LISTED, IT STAYS ON THAT BATTON.)	DETAILS
	8"	FIXED HOUSE VALANCE, PURPLE (FIXED AT 23' 7" HEIGHT)	FIXED
	1"4"	STRAIGHT LIFT FIRE CURTAIN	
1	2'	ADJUSTABLE HOUSE VALANCE, PURPLE	
	2' 8"	HOUSE MAIN CURTAIN, PURPLE, TRAVELER AND FLY	
2	3' 4"		
3	4' 0"	1 ST ELECTRIC (CIRCUITS 43-77)	
4	4' 8"		
5	5' 4"		
6	6' 0"	ACOUSTIC SHELL CEILING #1	
7	7' 4"		
8	8' 0"		
9	8' 8"	2 ND ELECTRIC (CIRCUITS 78-101)	
10	9' 4"	FULL STAGE BORDER LIGHT #1 (STRIP LIGHTS ON DROP BOX CIRCUITS)	
11	10' 0"		
12	10' 8"		
13	11' 4"		
14	12' 0"		
15	12' 8"		
16	14' 2"	ACOUSTIC SHELL CEILING #2	
17	14' 8"		
18	15, 4"	3 RD ELECTRIC (CIRCUITS 102-125)	
19	16' 0"		
20	16' 8"		
21	17' 4"		
22	18' 0"	FULL STAGE BORDER LIGHT #2	
23	18' 8"		
24	19' 4"	FULL STAGE BLACK TRAVELLER (TRAVELS AND FLYS)	
25	20' 8"		
26	21' 4"		
27	22' 0"	ACOUSTIC SHELL CEILING #3	
28	22' 8"		
29	23' 4"		
30	24' 0"		
31	24' 8"	4 TH ELECTRIC (CIRCUITS 126-149)	
32	25' 4"		
33	26' 0"	FULL STAGE BORDER LIGHT #3	
34	28' 1"		
35	28' 8"		
36	29' 4"	ACOUSTIC SHELL CEILING #4	
37	30' 0"		
38	30' 8"		
39	31' 4"		
40	32' 0"		
41	32' 8"	5 TH ELECTRIC (CIRCUITS 150-179)	
42	33' 4"		
43	34' 8"		
44	35' 4"		
45	36' 0"	SEAMLESS NATURAL WHITE MUSLIN CYCLORAMA	

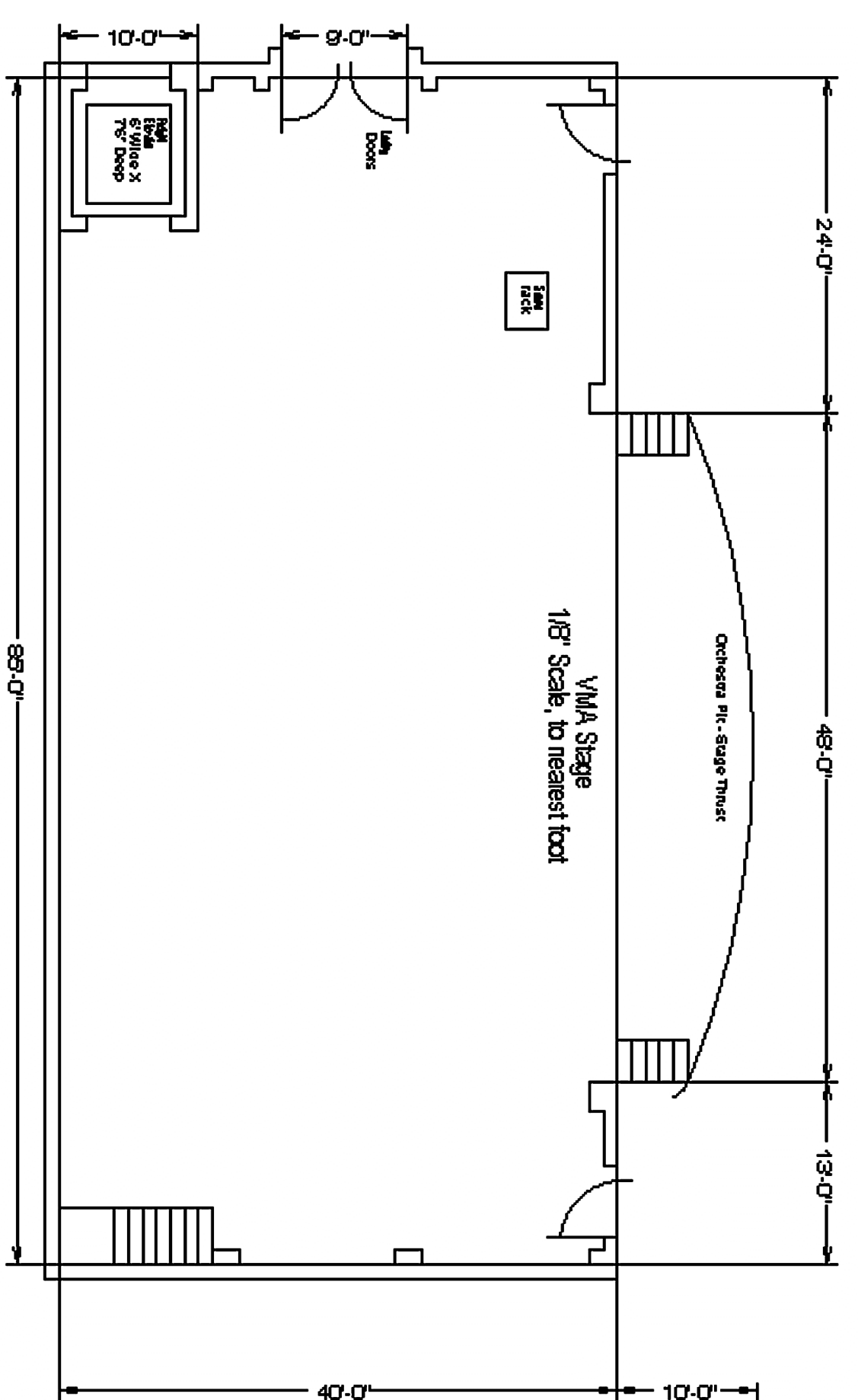

CIRCUIT LAYOUT

FRONT OF HOUSE	
Box Boom - House Left	1-12
Balcony Rail	13-24
Box Boom - House Right	25-36
STAGE ELECTRICS	
1 st Electric Consecutive order from Stage Left to Stage Right	43-77
2 nd Electric Consecutive order from Stage Left to Stage Right	78-101
3 rd Electric Consecutive order from Stage Left to Stage Right	102-125
4 th Electric Consecutive order from Stage Left to Stage Right	126-149
5 th Electric Consecutive order from Stage Left to Stage Right	150-179
STAGE DROP BOXES - 4 circuits per box, from grid iron	
Drop Box - Down Left	180-183
Drop Box - Mid Left	184-187
Drop Box - Up Left	188-191
Drop Box - Down Right	196-199
Drop Box - Mid Right	200-203
Drop Box - Up Right	204-207
FLOOR POCKETS - 3 circuits per pocket	
Floor - Down Left	212-214
Floor - Mid Left	215-217
Floor - Up Left	218-220
Floor - Down Right	221-223
Floor - Mid Right	224-226
Floor - Up Right	227-229
Floor – Up Center	230-232